

Instructions: Yori Surface Cove Rail

1. Turn off power at main switch before installing or modifying the system.
2. Read all of these instructions before installing.
3. Intended for installation by a qualified electrician be in accordance with NEC and all local codes
4. Do not install in damp or wet locations.
5. Fixture mounts to a wall or ceiling surface requires 6" minimum clearance for all adjacent structures.
6. Do not slide fixtures along the length of the channel.
7. Save these installation instructions.

Uses Yori surface mounted rail to fixtures to extend and aim down light from a ceiling cove.
Maximum run length is 10 fixtures.

Power options:

Power is introduced to a wiring compartment at the beginning of a run from either a conduit or std 4" J-box.

Conduit feed:

Bring building wire into the compartment through the KO hole.

Join building wires with fixture wires, white to white, black to black, and green or bare wire to green ground (using wire nuts supplied). Mount the Wiring compartment to the ceiling surface with screws (not supplied) and leave slack for latter adjustment.

J box feed: Pass building wires through the connector /hole in the canopy, then through the wiring compartment, thread nut onto connector and connect wiring as above.

Control wire: Wire control wires in the position shown in the diagram.

System overview

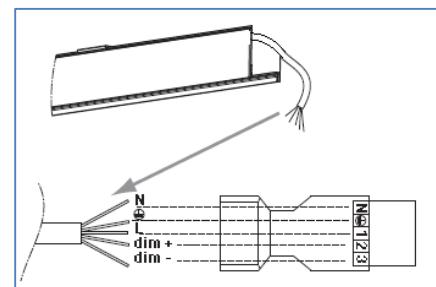
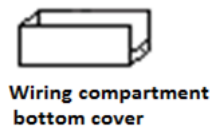
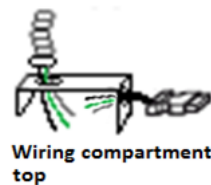
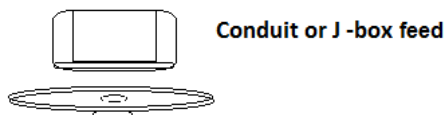
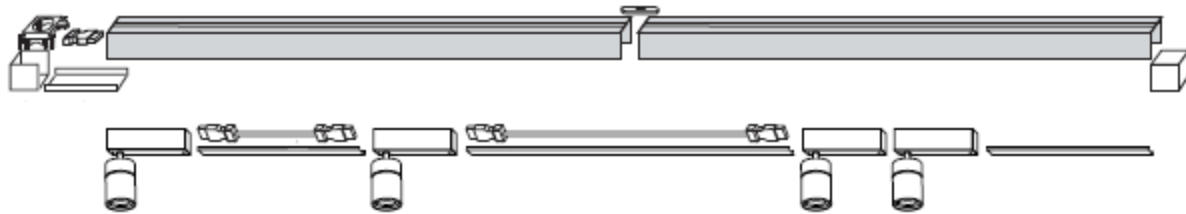

channel joiner

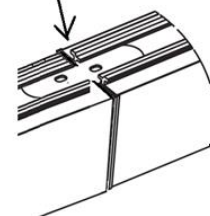

Mounting Options: Direct mount with screws or Clip mount (sold as an accessory and not repositionable.) When mounting Yori channel to surface make sure that the channel end is close to the wiring compartment (within ½" max) and mounting screws are left slack to allow the wiring compartment to be joined.

Mount rail by marking screw holes on the ceiling (using predrilled holes). Use minimum two screws for lengths up to 4ft and minimum 3 per 8ft length (supplied). Do not fully tighten. This will allow sufficient play to mate to wiring compartment. Join channel to Wiring compartment by sliding channel onto the aligning spring, then secure with a screw (supplied). Tighten all remaining screws. Tighten screws in wiring compartment.

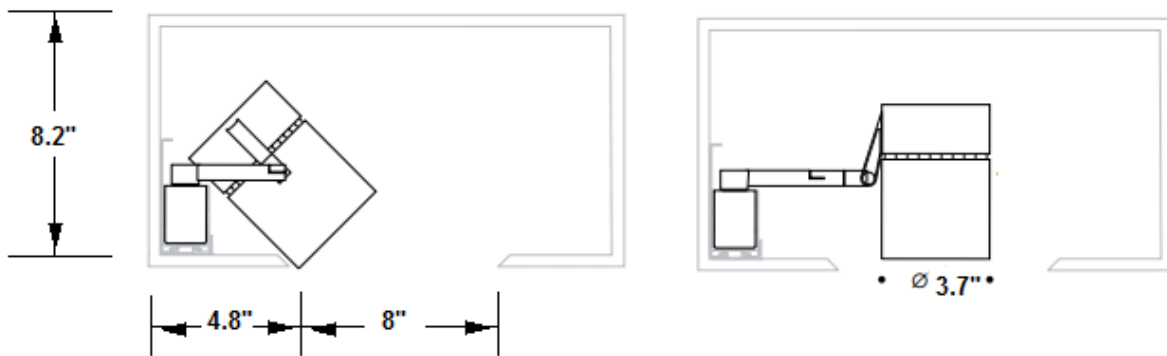
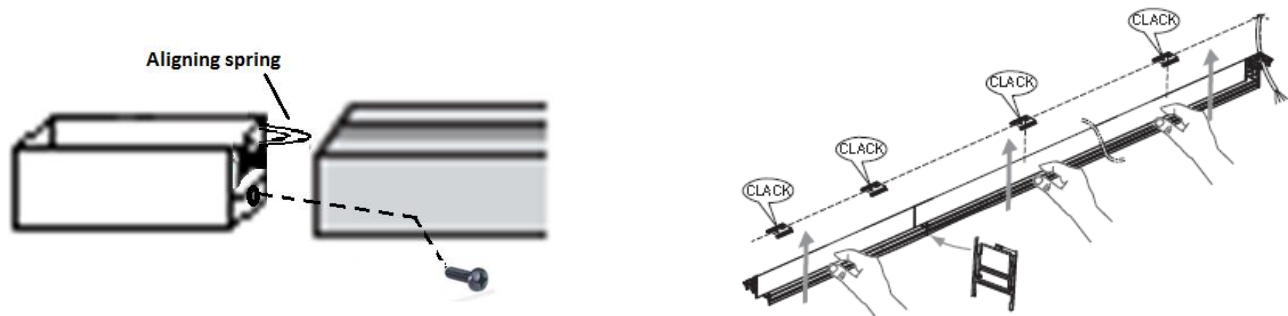

Joining fixtures: The wire connector exiting the wiring compartment supplies power to the first and all joined fixtures in a run (maximum run is 10 fixtures). Fixtures may be abutted or spaced apart with wires (see spec sheet for available lengths).

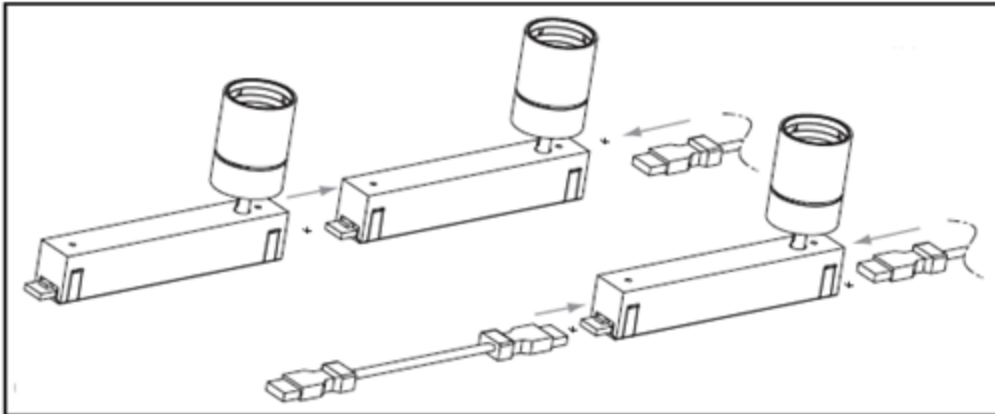

Install Individual heads by:

Raising fixture to the rail

Use the supplied key (or flat screwdriver) to retract the fixture retention springs, while pushing the fixture into the channel.

Counter turn 90 degrees to release and engage the retention springs.

- A Raise fixture to rail
- B Use key (or screwdriver) to retract mounting springs
- C Push fixture towards top of rail and release springs by counter turning 90°

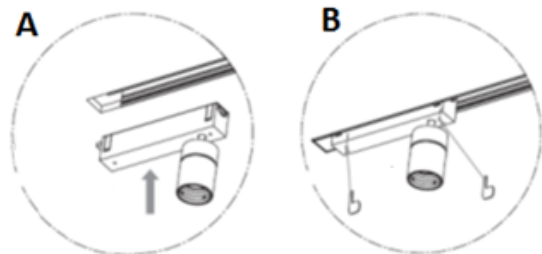

- A Raise fixture to rail
- B Use key (or screwdriver) to retract mounting springs
- C Push fixture towards top of rail and release springs by counter turning 90°



Install covers: Covers are available in precut lengths to match fixture wire combinations, or may be field cut to custom lengths. Wires cannot be field cut. Additional length can be taken up in the empty recess of the channel.

