

Installation instructions: Yori Trimless Recessed Rail

Important:

- Read all instructions before installing.
- Installation by a qualified electrician only.
- System is intended for installation in accordance with National Electric Code, and local regulations. Consult with local inspector to assure compliance.
- **To reduce the risk of fire, electrical shock and injuries to persons, turn off power at main switch before installing or modifying the system.**
- **Warning:** (Risk of fire) do not install insulation within 3 inches of fixture sides, or junction box, or in a manner to entrap heat.
- Retain instructions for future maintenance reference.

Prior to Ceiling Installation

1. Secure cable through clamp and bracket in ceiling cup.
2. Attach hanging clamps to top of channel. Minimum of 2 clamps for lengths up to 4ft.
3. Secure ceiling cup assembly and adjust cable to desired length and level.
4. Join building wires with fixture wires in wiring compartment, white to white, black to black, and green or bare wire to green ground. attach to fixture via terminal block (press to open).
5. Using screw provided, attach wiring compartment to the channel ensuring a tight fit.
6. To add consecutive channels for longer lengths, use joiner provided.

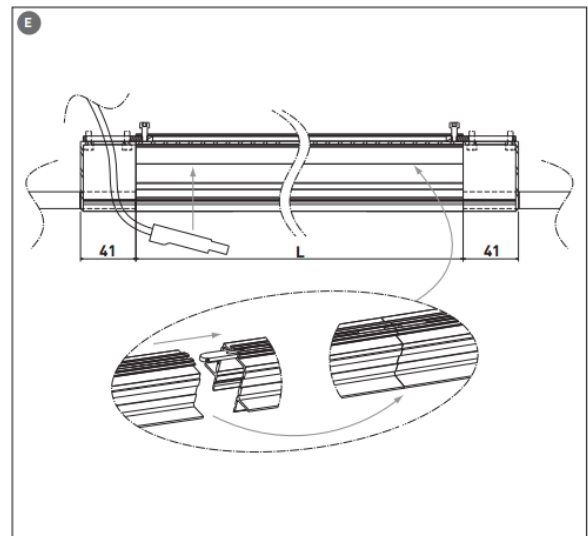
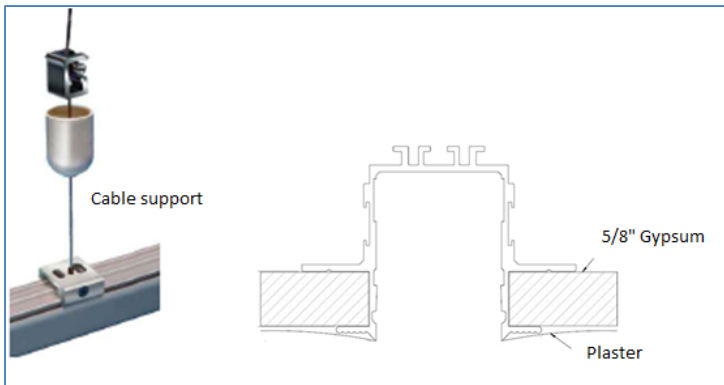

7. Install 5/8" thick gypsum ensuring gypsum is snug between resting flange and mudding flange.
8. Install aligner brackets every 19.5". It is important to install one at the joining of two channels.

Reggiani

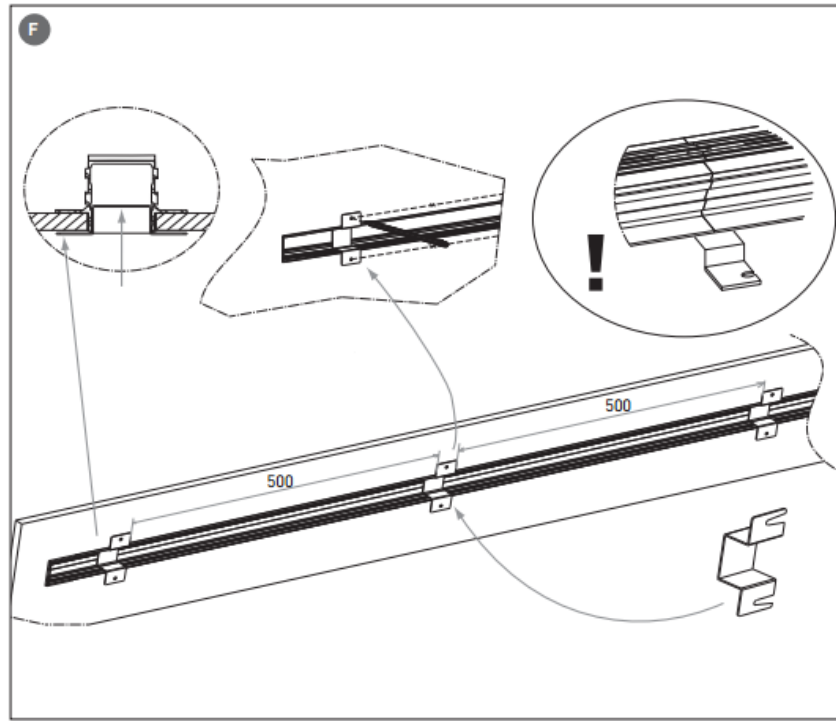

9. Using the alignment tool provided, screw holes next to the mudding flange, through gypsum, and into the extrusion.

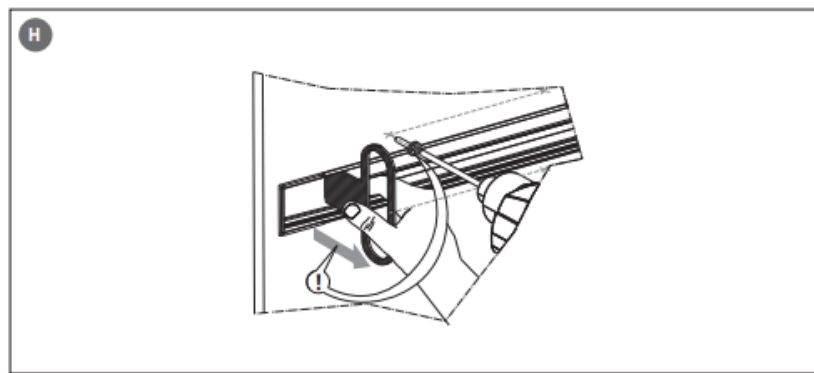
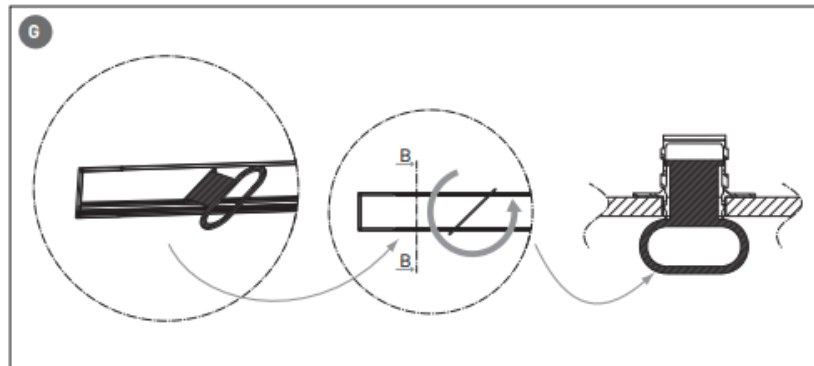

10. Plaster over the mudding flange and cover any screws.

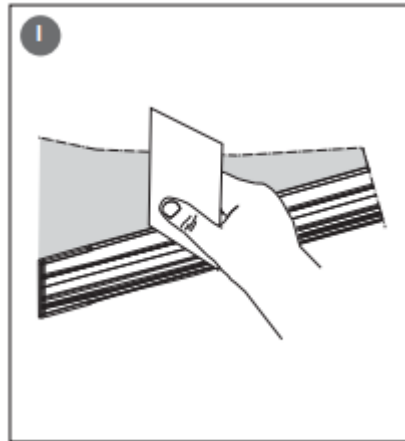

Fixture Installation

1. Attach wire connector exiting the wiring compartment to the first fixture of the run.
2. Raise fixture into channel where first fixture is to be placed. Insert key (supplied) into slot on fixture. Ensure key is pressed in as far as it can go. Turn 90 degrees and push fixture to top of mounting channel. Release and repeat in the second slot. A click will sound to indicate springs are engaged into channel. Press on fixture box to confirm fixture is seated in channel.

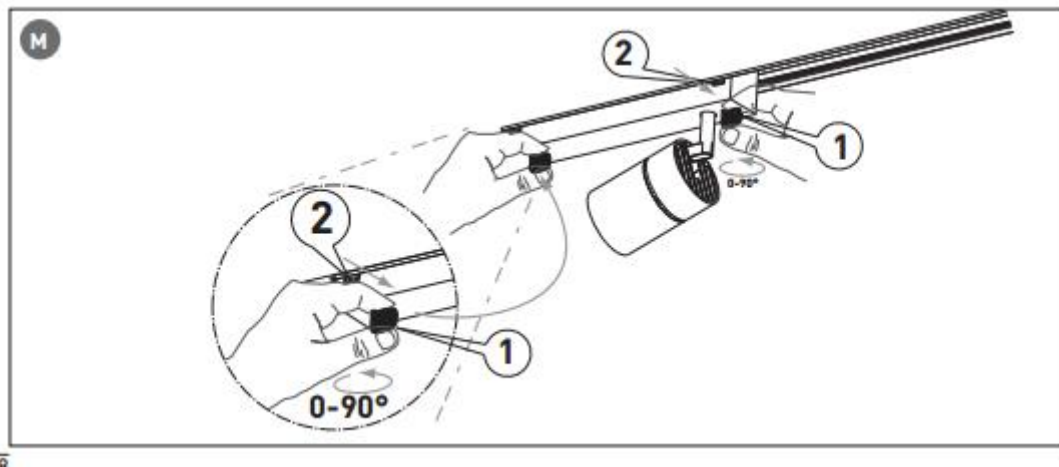

Reggiani

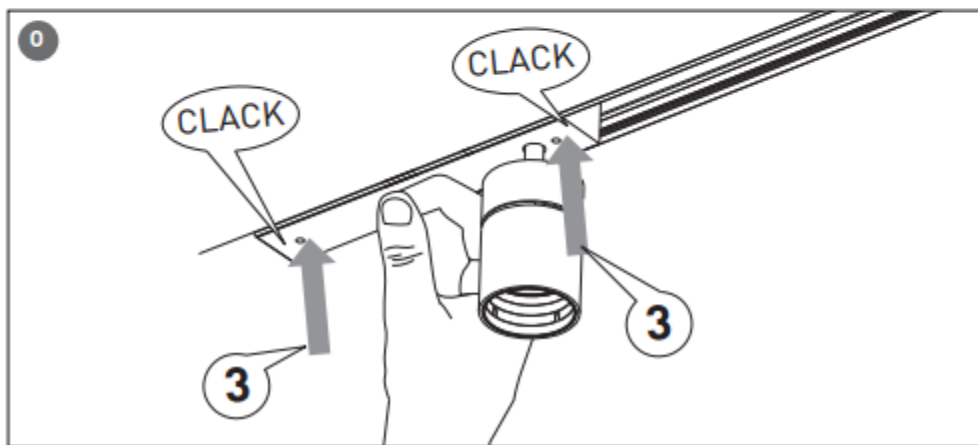
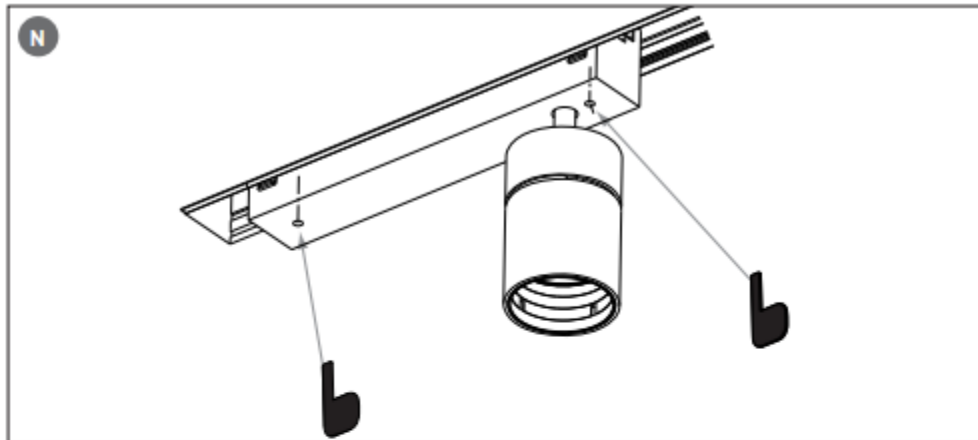

3. Snap in cover over wiring compartment. Slide first fixture to the wire cover. Ensure there is no gap between the cover and the first fixture.

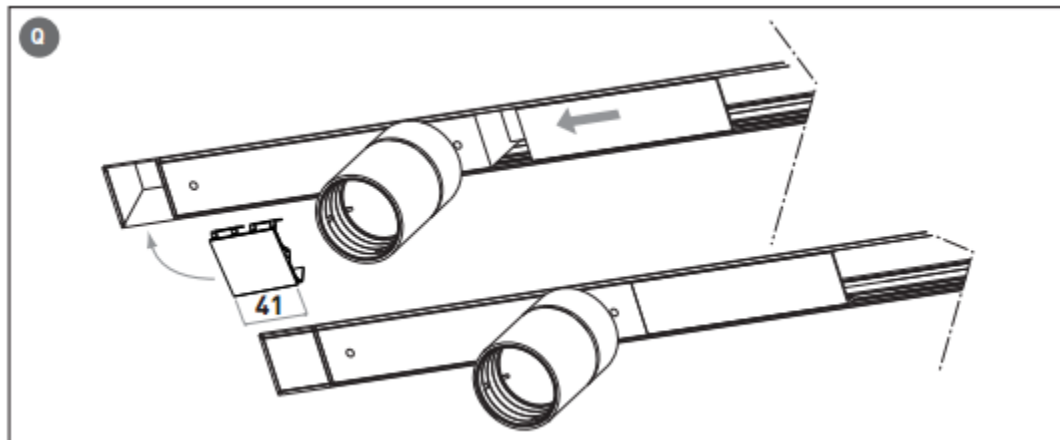

4. Install subsequent fixtures by mounting 1" from mating fixture, and then slide to join mating connectors.

Reggiani

5. Otherwise, install wire connectors between fixtures. Then install fixture in to channel. Install covers. Adjust position of fixtures to align with covers using caution not to stress wire connection.

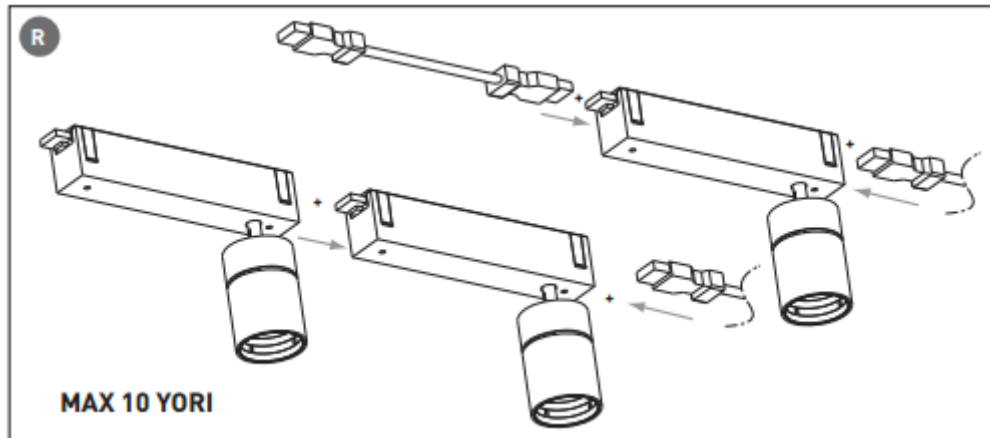

Instructions: Yori Surface or Pendant Mounted Rail

1. Turn off power at main switch before installing or modifying the system.
2. Read all of these instructions before installing.
3. Intended for installation by a qualified electrician be in accordance with NEC and all local codes
4. Do not install in damp or wet locations.
5. Fixture mounts to a wall or ceiling surface requires 6" minimum clearance for all adjacent structures.
6. Do not slide fixtures along the length of the channel.
7. Save these installation instructions.

Fixture may be directly mounted to the ceiling surface or suspended via rigid tube or steel cable. Maximum run length is 10 fixtures.

Ceiling mount Power options:

Power is introduced to a wiring compartment at the beginning of a run from either a conduit or std 4" J-box.

Conduit feed:

Bring building wire into the compartment through the KO hole.

Join building wires with fixture wires, white to white, black to black, and green or bare wire to green ground (using wire nuts supplied). Mount the Wiring compartment to the ceiling surface with screws (not supplied) and leave slack for latter adjustment.

J box feed: Pass building wires through the connector /hole in the canopy, then through the wiring compartment, thread nut onto connector and connect wiring as above.

Control wire: Wire control wires in the position shown in the diagram.

System overview

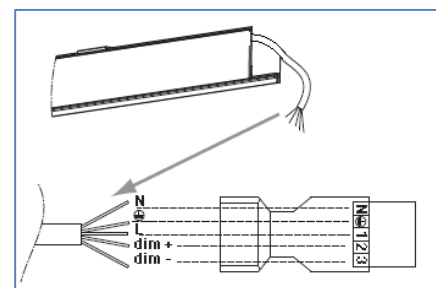
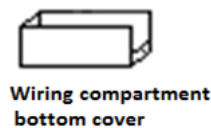
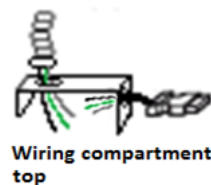
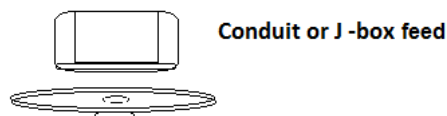
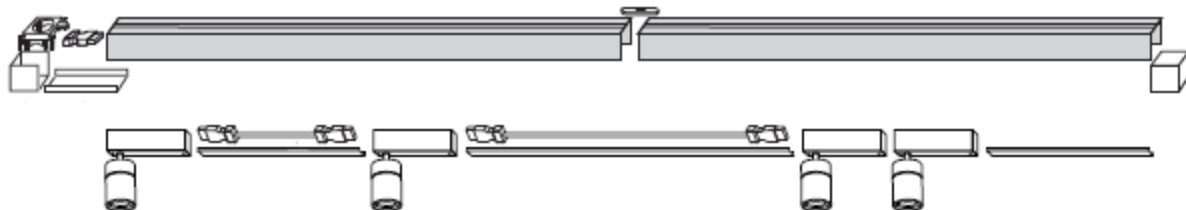

channel joiner

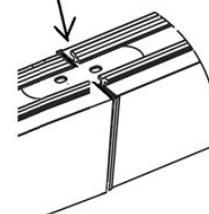

Reggiani

Mounting Options: Direct mount with anchors (supplied) (provides opportunity to reposition rail if needed) or Clip mount (sold as an accessory and not repositionable.) When mounting Yori channel to ceiling surface make sure that the channel end is close to the wiring compartment (within ½" max) and mounting screws are left slack to allow the wiring compartment to be joined.

Mount rail by marking screw holes on the ceiling (using predrilled holes). Use minimum two anchors for lengths up to 4ft and minimum 3 per 8ft length (supplied). Drill 3/8" holes into the ceiling. Insert screw through channel then 1/8" into anchor head, and then push into ceiling. Do not fully tighten. This will allow sufficient play to mate to wiring compartment. Join channel to Wiring compartment by sliding channel onto the aligning spring, then secure with a screw (supplied). Tighten all remaining anchor screws. Tighten screws in wiring compartment.

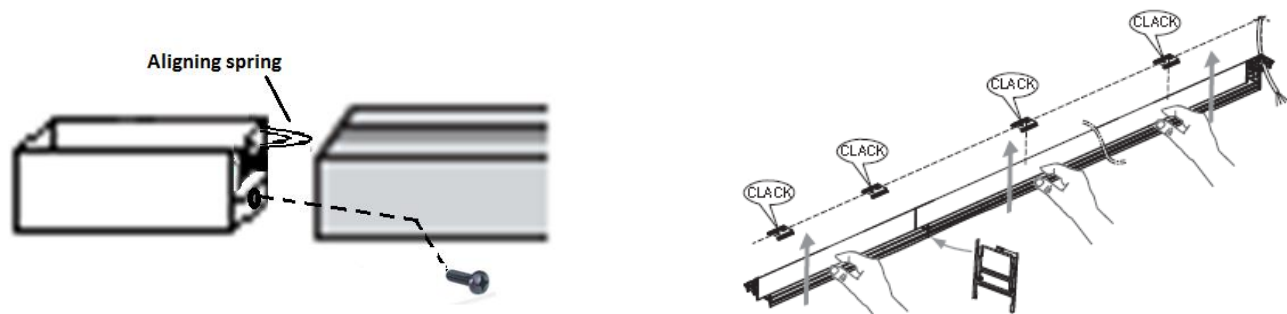

Suspended Mounting Options: Rail may be suspended by aircraft cable or threaded rod, or tube (ordered as accessories).

Cable: Cables are supplied in 5ft lengths with mini ceiling canopies. Cable adjustment occurs in the canopy. Brackets secure to top of channel and are easily repositioned. Power feed is positioned under a J-box and is accomplished with SVT power cord & 5" canopy (ordered as an accessory). Building wire connection takes place in the J-box (not suitable for control wires).

Threaded rod: Brackets secure to top of channel and are easily repositioned. Uses same power feed accessory described above.

Tube: Available in 4 ft. lengths. Uses ceiling canopies with cross bars and brackets to secure to channel. May be powered thru SVT wire and canopy or may use tube to feed building wire from a J-box to the wiring compartment..

Reggiani

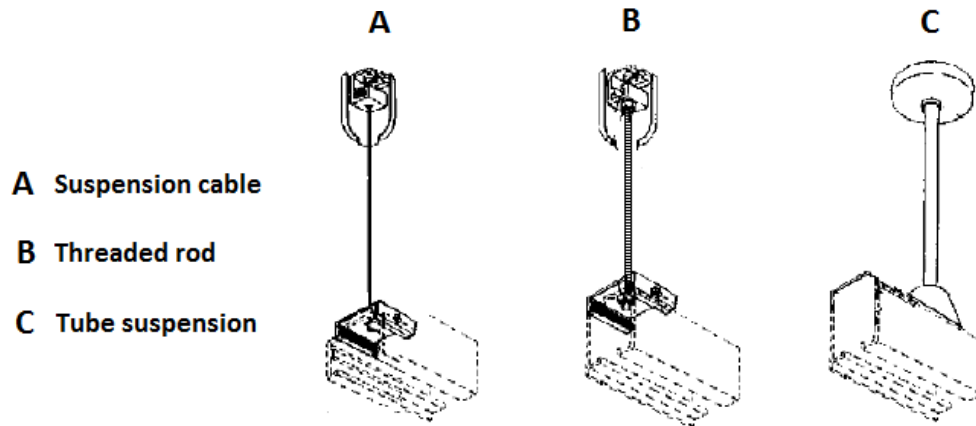

Installing fixtures: The wire connector exiting the wiring compartment supplies power to the first and all joined fixtures in a run (maximum run is 10 fixtures). Fixtures may be abutted or spaced apart with wires (see spec sheet for available lengths).

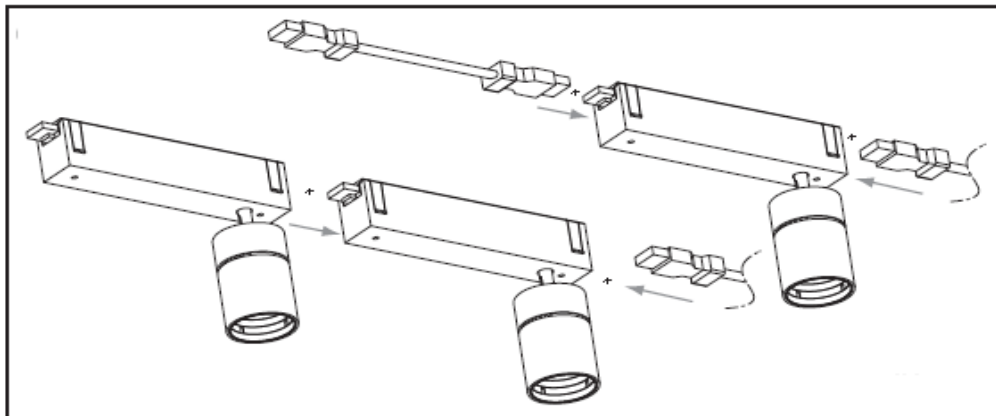

Install Individual heads by:

Raising fixture to the rail

Use the supplied key (or flat screwdriver) to retract the fixture retention springs, while pushing the fixture to the top of the channel.

Counter turn 90 degrees to release and engage the retention springs.

- A Raise fixture to rail
- B Use key (or screwdriver) to retract mounting springs
- C Push fixture towards top of rail and release springs by counter turning 90°

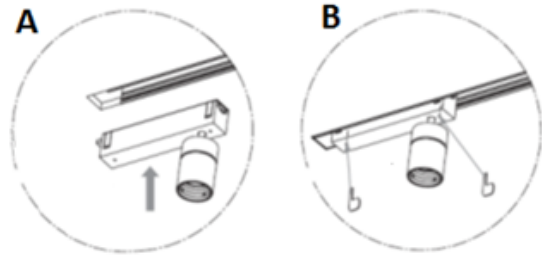

- A Raise fixture to rail
- B Use key (or screwdriver) to retract mounting springs
- C Push fixture towards top of rail and release springs by counter turning 90°

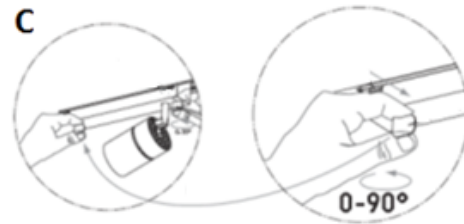

Install covers: Covers are available in precut lengths to match fixture wire combinations, or may be field cut to custom lengths. Wires cannot be field cut. Additional length can be taken up in the empty recess of the channel.

